

# TANDEM 1000 WELDING TORCH

## MIG/MAG EN 60 974-7



# Tandem 1000 Welding Torch

## Features & Benefits

Tandem welding requires robust equipment that can handle high amperages and duty cycles. ABICOR BINZEL USA's Tandem 1000 welding torch offering is reliable, technically sound, and ready to take on the high demands of tandem welding.

The Tandem 1000 welding torch comes equipped with durable, long-life consumables meaning less consumable changes. When maintenance is required, the design of the torch makes consumable changes and part swaps fast and easy.

### Features & Benefits

- Up to 1000A mixed gases 100% duty cycle
- Parallel or converging contact tip angles
- Patent-pending field adjustable contact tip spacing from 12.5 - 29 mm (1/2" - 1 9/64"), depending on model
- Quick-release water-cooled gas nozzle
- Wire advance push buttons

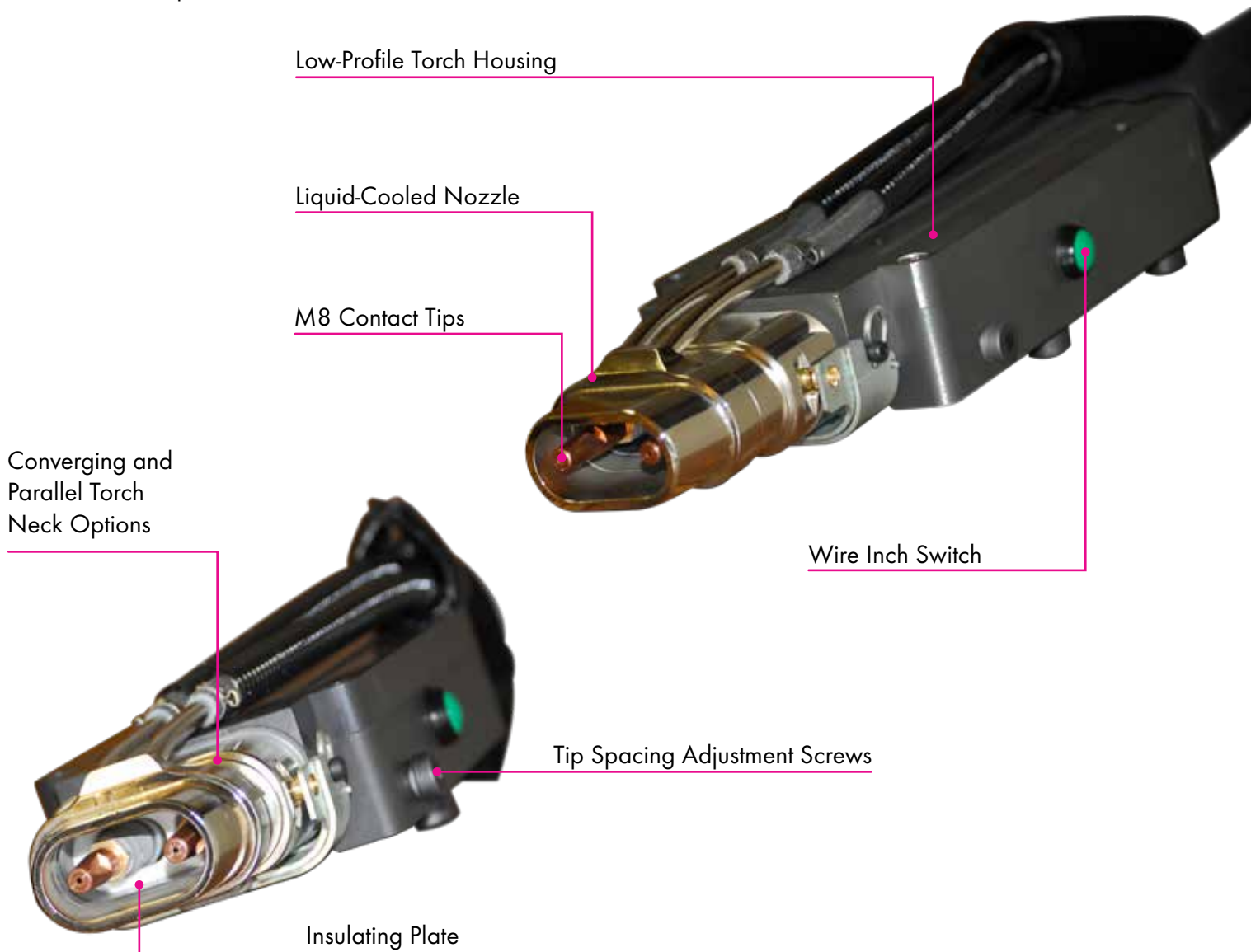

# Tandem 1000 Welding Torch

## Technical Specifications

<b>Type of Cooling:</b>	Liquid
<b>Shielding Gas:</b>	CO2 or M21 mixed gas in compliance with DIN 439
<b>* Rating Mixed Gas M21:</b>	** Up to 500A each cable/1000A system total IEC rated using 3 re-circulators rated at 1200W each
<b>Duty Cycle:</b>	100%
<b>Wire Diameter:</b>	0.9mm - 1.6mm (.035" - .062")
<b>Gas Flow:</b>	10 - 20 L/min. (21 - 42 CFH)
<b>Type of Voltage:</b>	DC
<b>Electrode Polarity:</b>	Generally Positive
<b>Wire Type:</b>	Standard round wires
<b>Type of Guide:</b>	Automatic
<b>Tip Spacing, Parallel:</b>	Adjustable 15mm - 29mm (19/32" - 1 9/64")
<b>Tip Spacing, Converging:</b>	Adjustable 12.5mm - 26.5mm (1/2" - 1 3/64")
<b>Tip/Wire Angle:</b>	Parallel or converging
<b>Voltage Measurement:</b>	Peak value of 141V
<b>Connection Protection Machine Side:</b>	IP2X

\* According to EN 60 974-7

\*\* Reduced up to 35% when pulse welding

# Tandem 1000 Welding Torch

## Ordering Information & Replacement Parts

TT	-	10	E	-	P
Torch Model		Cable Length	Wire Feeder		Torch Necks
<b>Model</b>			<b>Torch Necks</b>		
TT - Tandem Torch Package			C - Converging P - Parallel		
<b>Cable Length</b>			<b>Wire Feeder</b>		
50 - 5' 10 - 10'			E - Euro L - Lincoln 7 style M - Miller N - Lincoln 10 style P - Panasonic		

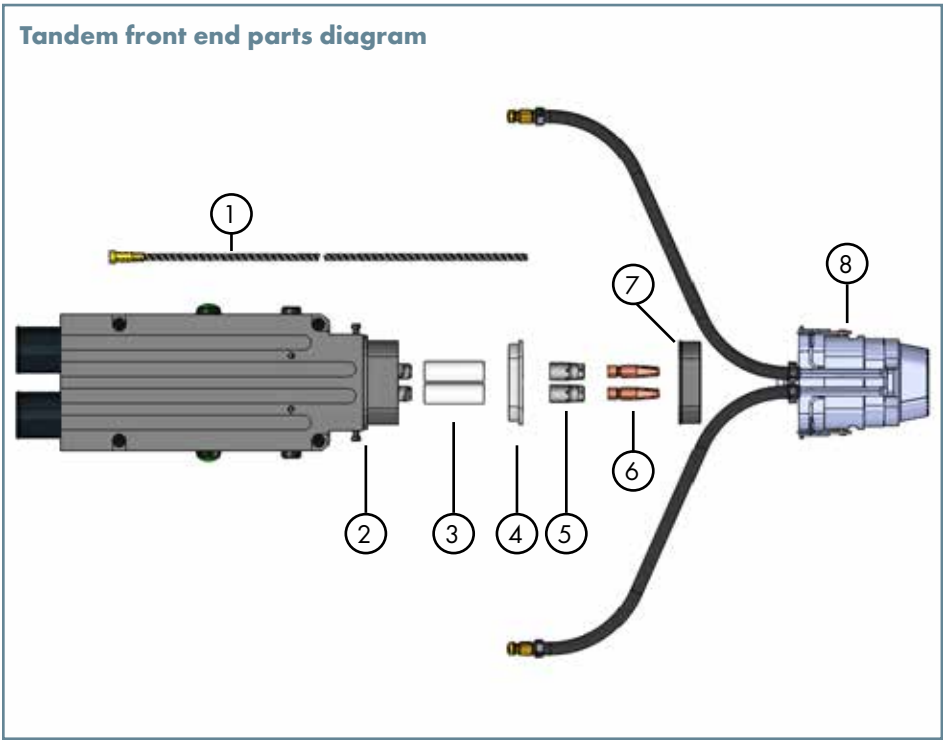

	Description	Part No.
1	Liner Steel .035"-.045" (0.9 - 1.2mm)	122.9057
*	Liner Steel .052"-.062" (1.4 - 1.6mm)	122.9058
2	* Nozzle seal	962.1463
3	* Isolation tubes	000.9166.US
4	* Insulating plate	146.9062.US
5	* Tip holder M8	142.9056.US
6	Contact tip .035" (0.9mm)	140.1207
	Contact tip .040" (1.0mm)	140.0939
*	Contact tip .045" (1.2mm)	140.0453
	Contact tip .052" (1.4mm)	140.0958
	Contact tip .062" (1.6mm)	140.0964
7	* Nozzle insulator	146.0086
8	* Nozzle assy complete	145.9054.US

\*Included with standard torch packages

### KIT.9036 Consumable Kit .045" / .052" (1.2 / 1.4mm)

Item Number	Description	Qty.
146.0086	Nozzle insulator	1
146.9062.US	Insulator plate	1
142.9056.US	Tip holder M8	6
145.9054.US	Nozzle CPL	1
140.0453	Contact tip .045" (1.2mm) M8	25
140.0958	Contact tip .052" (1.4mm) M8	25
962.1463	Nozzle seal	5

### KIT.9037 Consumable Kit .045" / .045" (1.2 / 1.2mm)

Item Number	Description	Qty.
146.0086	Nozzle insulator	1
146.9062.US	Insulator plate	1
142.9056.US	Tip holder M8	6
145.9054.US	Nozzle CPL	1
140.0453	Contact tip .045" (1.2mm) M8	25
962.1463	Nozzle seal	5

# Tandem 1000 Welding Torch Accessories

## Coolants

Coolants lubricate the pump, liner, gasket and seal, thus extending the time between preventive maintenance. Various coolants also minimize damaging mineral deposits that build up internally during operation.

### ABI-Cool LC



An inhibited blend of deionized water and ethylene glycol. ABI-Cool has a lower viscosity and doesn't require as much power to pump. Rated -32° F / -35° C. Our new low conductivity blend increases the life span of torch necks by reducing risk of galvanic corrosion while decreasing risk of voltage leaks.

**P/N 192.0232 (1 gallon container)**  
**P/N 192.0233 (5 gallon container)**  
**P/N 192.0234 (55 gallon container)**

### ABI-CoolEco



An inhibited blend of deionized water and propylene glycol, this formula is non-toxic and safe for use in areas where people may come in contact with the coolant. Its corrosion inhibitors protect iron, steel, aluminum, brass and copper components. Rated +10° F / -12° C

**P/N 192.9022 (1 gallon container)**  
**P/N 192.9023 (5 gallon container)**  
**P/N 192.9024 (55 gallon container)**

### BTC-50



BTC-50 coolant protects liquid cooled welding or cutting torches from frozen cooling channels, by preventing electrolytic corrosion of the metal surfaces within these channels due to its low conductivity of <math><4\mu\text{S}</math>

**P/N 192.0175 (5 Liter container)**  
**P/N 192.0176 (20 Liter container)**  
**P/N 192.0177 (200 Liter container)**

*The thermal stability and dielectric properties of coolants make them suitable for plasma, arc welding and tungsten inert gas welding systems and general industrial applications.*

## Anti-Spatter

### ABI-Shield Ceramic Protective Spray



Aerosol ceramic anti-spatter coating. Thin coating creates a solid protective barrier against spatter on consumables, fixtures, and tools.

A single application required for 6 hours of welding means less downtime in both robotic and hand-held welding applications.

13.5 oz. cans sold by the case. Use with the Ceramic Coating Cap!

**P/N 192.0228.12 (12-pack)**

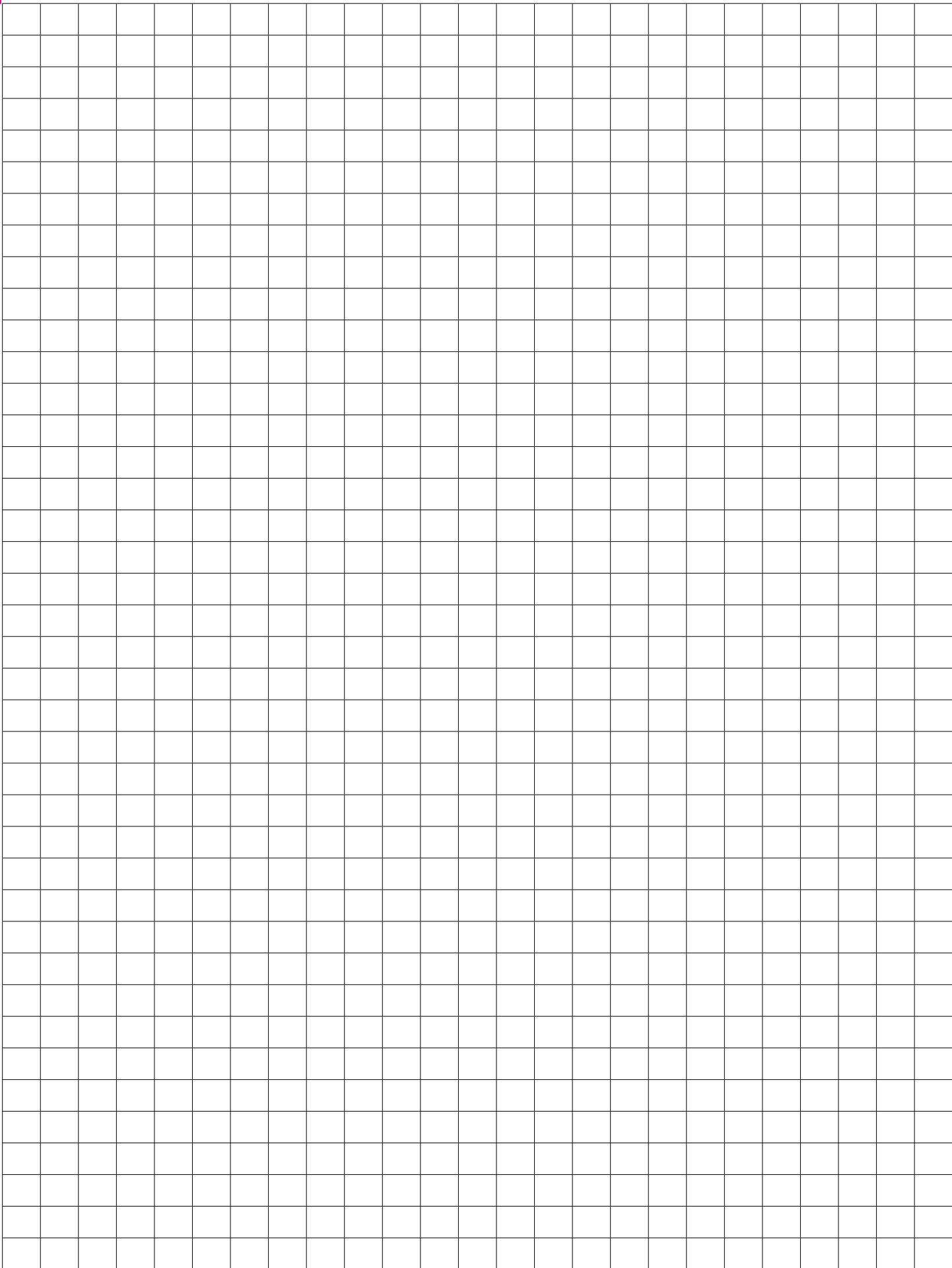

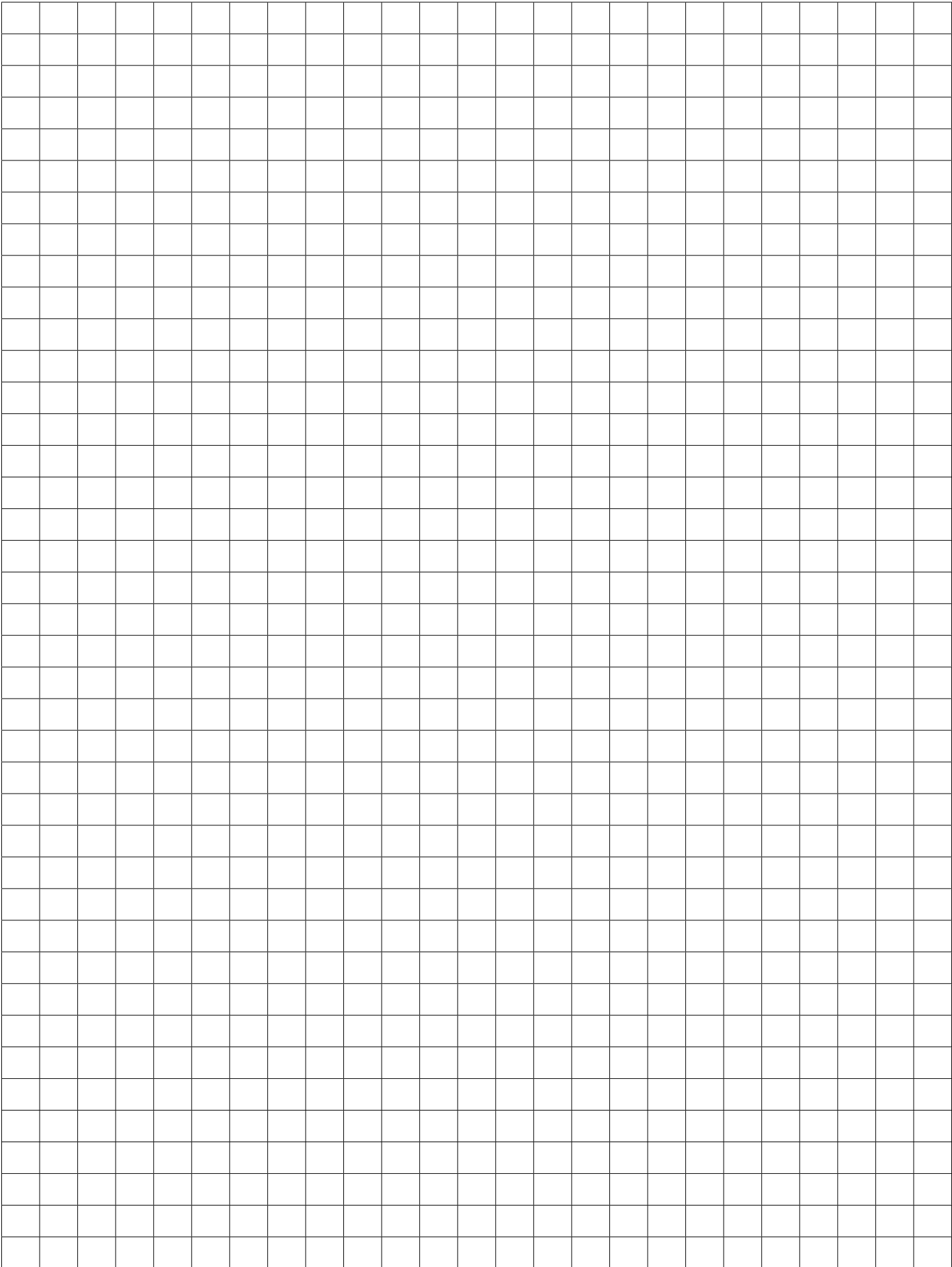



ABICOR BINZEL USA, Inc.  
650 Medimmune Court, Suite 110  
Frederick, MD 21703  
Phone: 800.542.4867  
Fax: 301.846.4497  
E-Mail: [customerservice@abicorusa.com](mailto:customerservice@abicorusa.com)

[www.binzel-abicor.com](http://www.binzel-abicor.com)